

This includes but is not limited to the following 4 external accelerometers Models:

Dataclutch 8G    Dataclutch 5G    Dataclutch 4G FWD    PCB Piezotronics

Mounting Surface To Be Stiff  
Mounting Surface Must Resist Vibration  
Accelerometer is to be mounted level and square as the car sits with wheels on level ground with fuel and driver.  
The Forward Facing Side Must Be Perpendicular to Forward Direction of Car.

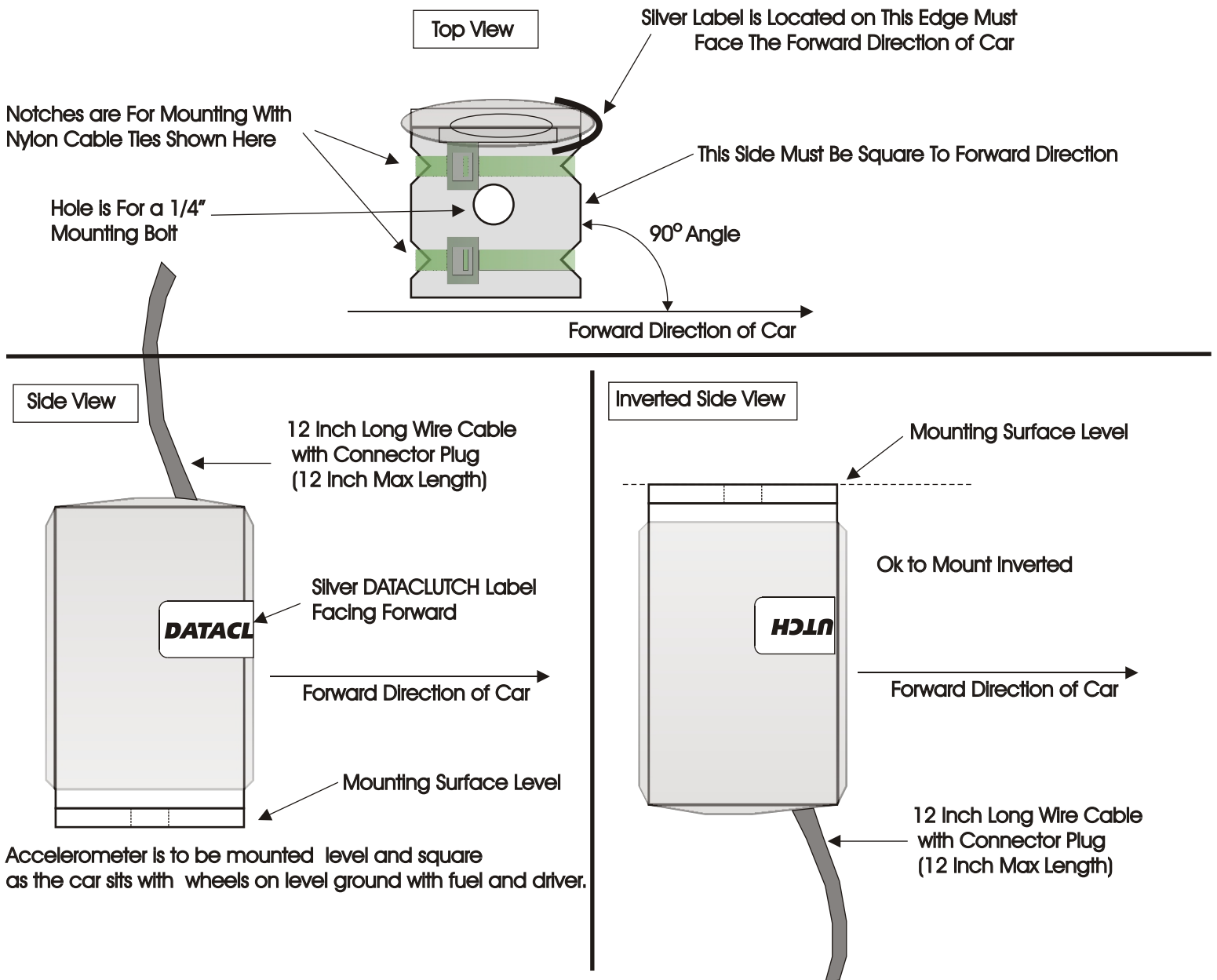

The NARROW SIDE or EDGE of the accelerometer WITH SILVER label MUST FACE IN THE CARS FORWARD DIRECTION..